



# WILLOW CREEK AT BEARSPAW



---

## FAQs

### 1. Do we have to build right away?

*No. Once you own your lot you have 15 months to plan and design your home and an additional 18 months after that to complete the exterior.*

### 2. What are the terms and conditions of purchasing a lot?

*We ask that you put 10% down (held In Trust) on signing paperwork with the balance due on closing.*

### 3. Who are the builders?

*We have selected 5 of the best award-winning, custom home builders in the Calgary area and we encourage you to speak with them to get a sense of which company is the best fit for you and your family.*

Our Premier Builders group:

*Astoria Custom Homes, [www.asotriahomes.ca](http://www.asotriahomes.ca)*

*Canterra Custom Homes, [www.canterracustomhomes.com](http://www.canterracustomhomes.com)*

*Hyatt Homes, [www.hyatthomes.ca](http://www.hyatthomes.ca)*

*Laratta Homes, [www.larattahomes.com](http://www.larattahomes.com)*

*McKinley Masters Custom Homes, [www.mckinleymasters.com](http://www.mckinleymasters.com)*

### 4. What is the minimum building size?

*2000 square foot bungalow or 2500 square foot two storey home.*

### 5. What is included in the lot price?

*Water hook-up (provided by the Rocky View Water Co-Op), Natural Gas, Electricity, Telephone and Cable to the property line.*

*Hand-carved Natural Stone Features – logo and address engraved by local artist and mason.*

---

*Simply. the best...*

[www.willowcreekbearspaw.com](http://www.willowcreekbearspaw.com)

Inquiries (403) 374-2580 | Email: [info@willowcreekbearspaw.com](mailto:info@willowcreekbearspaw.com)



# WILLOW CREEK AT BEARSPAW

## Location

Quick access to:

- ☞ The City - 4 or 6 lanes to downtown with only a handful of traffic lights
- ☞ The Airport - less than 30 minutes door-to-door
- ☞ Your Mountain Playground - only an hour away

## Site

- ☞ Mountain views from every home site
- ☞ Breathtaking waterscapes - over 14 acres of integrated ponds and creeks
- ☞ 30 acres of open space (20% of the site) and 4.5kms of natural trails to enjoy

## Value

- ☞ Over \$2.0 Million in engineering, earthworks and waterscape construction
- ☞ 2 acre lots equivalent to 6 or 10 city sized lots

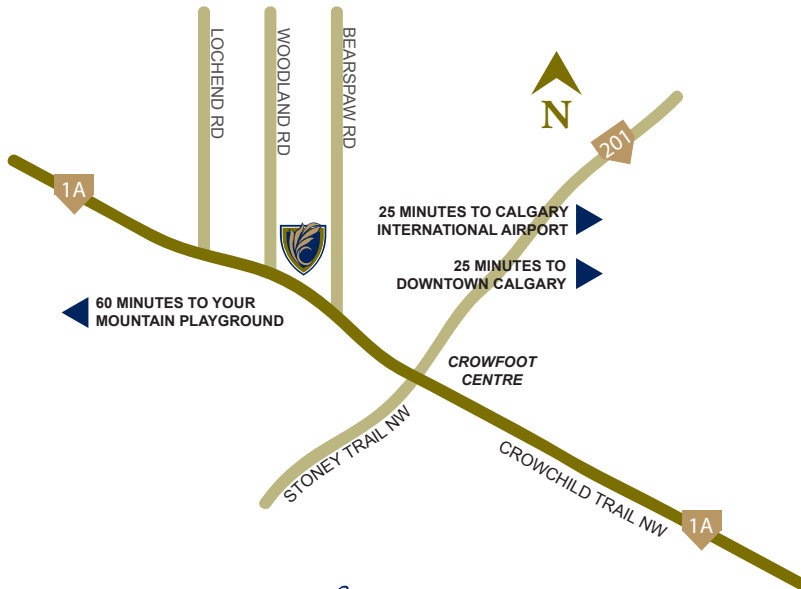

*Simply, the best...*

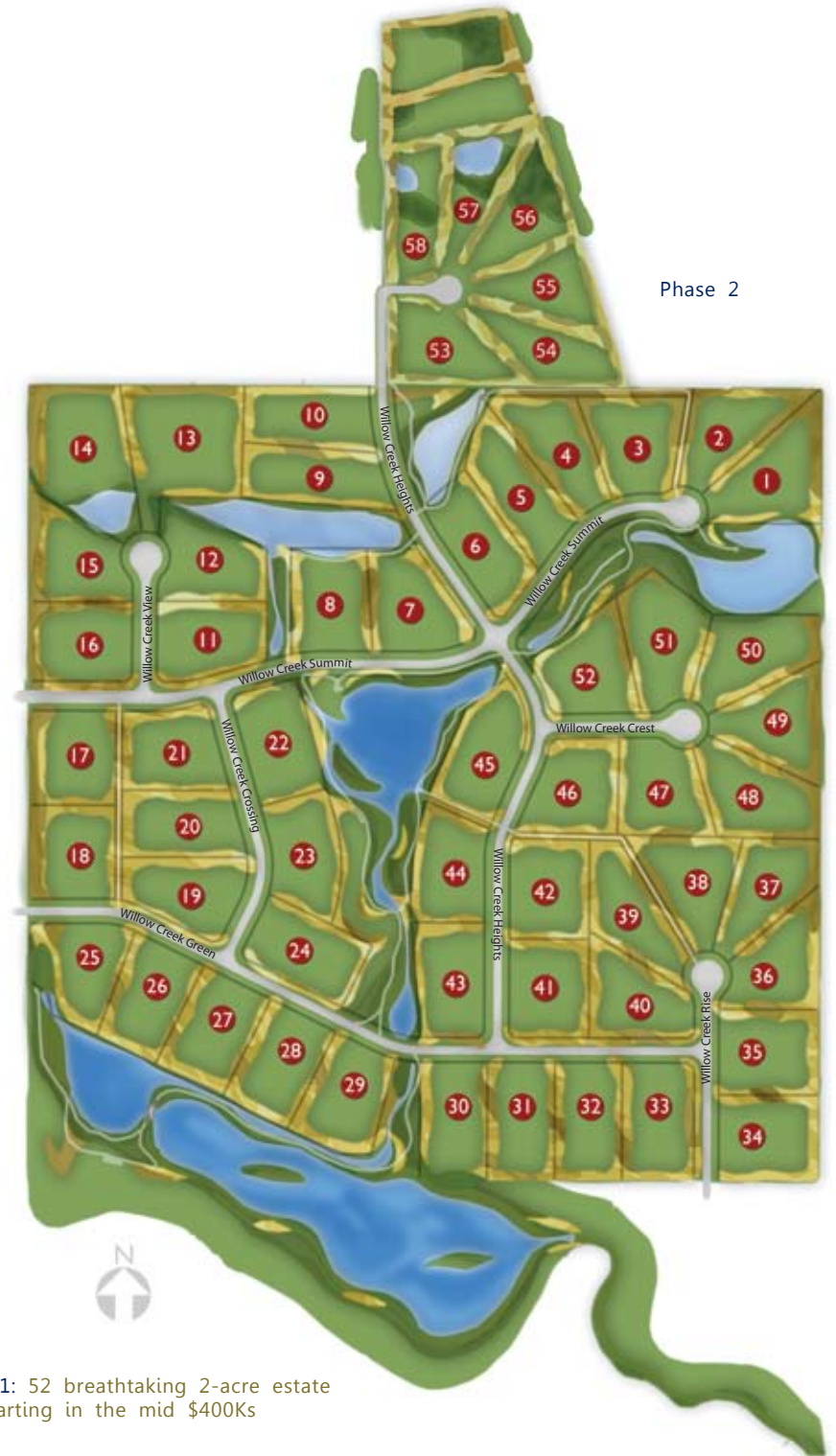

Phase 1: 52 breathtaking 2-acre estate lots starting in the mid \$400Ks